

# QUICKFLEX WALLS®

vari®



# READY, SET, ROOM

Modular QuickFlex Walls® make it easy to create offices and meeting spaces fast. Setup is literally a snap. Now you can transform your existing space without the drywall cost, construction permits, or downtime. And when your needs change, you can simply reconfigure your design.



# FUTURE-PROOF YOUR OFFICE



## Fast

QuickFlex Walls are designed from the ground up to assemble quickly. There's no need for licensed experts, specialized tools, or building permits. You can practically have an office setup faster than it takes to get a contractor on the phone.

## Flexible

Now you can add rooms or divide spaces as your business changes without being restricted to drywall and structural elements. Plus, you can mix panel finishes to include clear, frosted, whiteboard, and felt to create the look that's right for you.

## Simple

QuickFlex Walls assemble and reassemble in minutes, so you can create personalized spaces that work for all your business needs. The special post-and-panel system is simple enough for anyone to set up, saving you time and money on installation.

ADAPTABILITY  
ENGINEERED

## Quick-Locking System

Patented design for easy setup means no special tools or professional crew required, saving you time and money on installation and reconfiguration.

## Heavy-Duty Materials

QuickFlex Walls are constructed with durable, heavy-duty aluminum and tempered glass or felt panels to stand the test of time.

## Modular Design

Choose from full or split panels available in a variety of functional surfaces like writable glass for whiteboards or felt panels for privacy and sound absorption.

## Certified Quality

Tested to meet or exceed ANSI/BIFMA X5.6 Standards, Greenguard and Greenguard Gold Certified, and also UL1286 Listed, UL723 Certified (Felt Panels Only), and SGCC Certified (Glass Panels Only).



# Choose Your Frame



# Choose Your Finish

Choose between slate or silver frames, then select from functional finishes like clear or frosted writable glass or sound-dampening, felt panels.

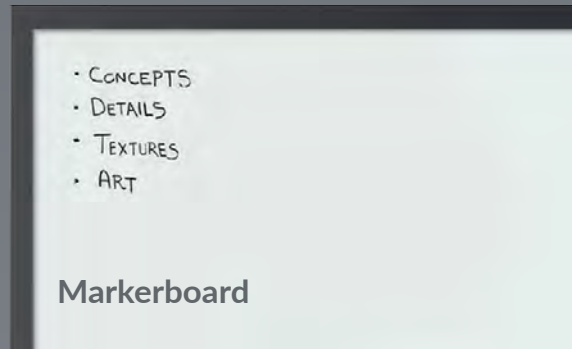
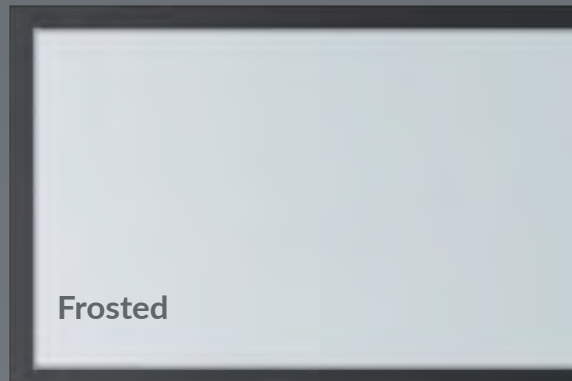
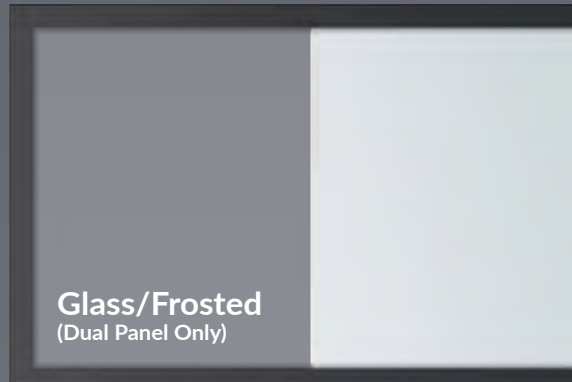
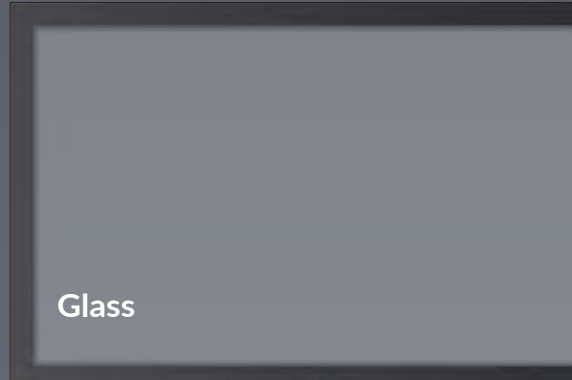

# Choose Your Panel

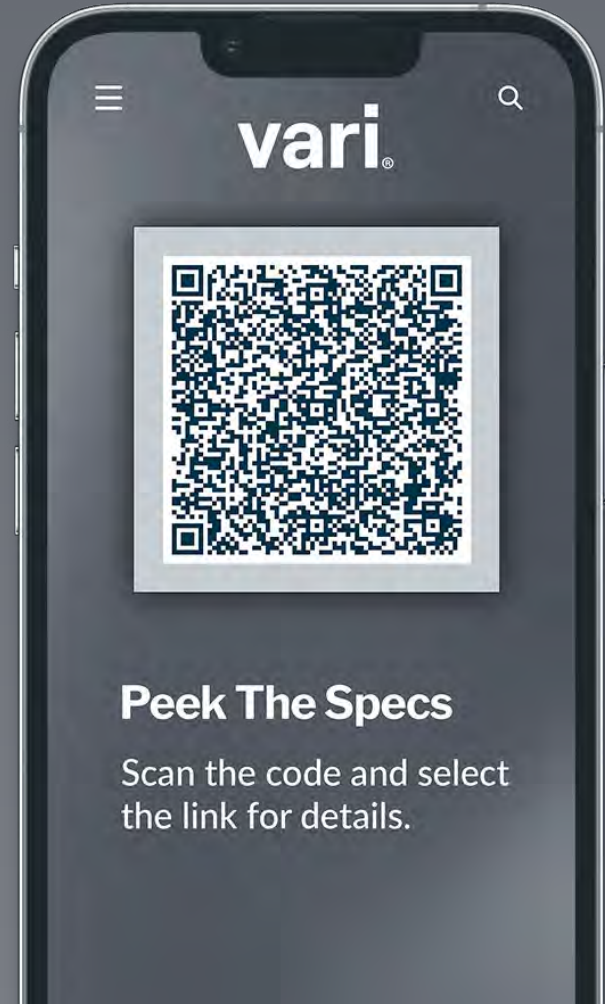
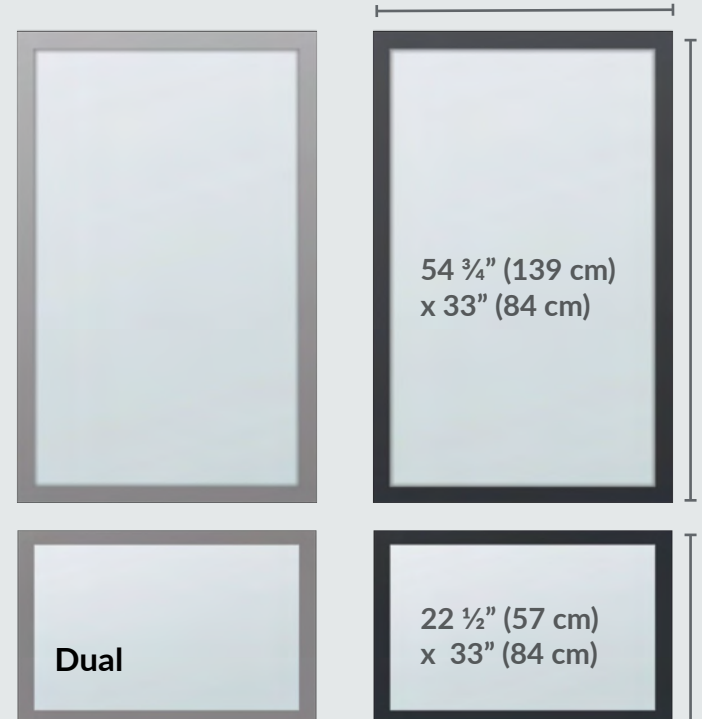

## Peek The Specs

Scan the code and select the link for details.

# STABLE & EXTENDABLE



## Stability Brace

Low-profile attachment for additional stability.

## Anchor Base Plate

Bolts to floor to provide stability in compliance with seismic code requirements.



## Stability Bracket

Designed to distribute weight for maximum stability.

## Powerstrip Bracket

Easily add electrical outlets to any room with a wall-mounted Power Strip.



## Stability Rail

Attaches along the top to link panels for strength.

## Felt Extension Panels

24" or 36" height panels attach to increase privacy and sound dampening.

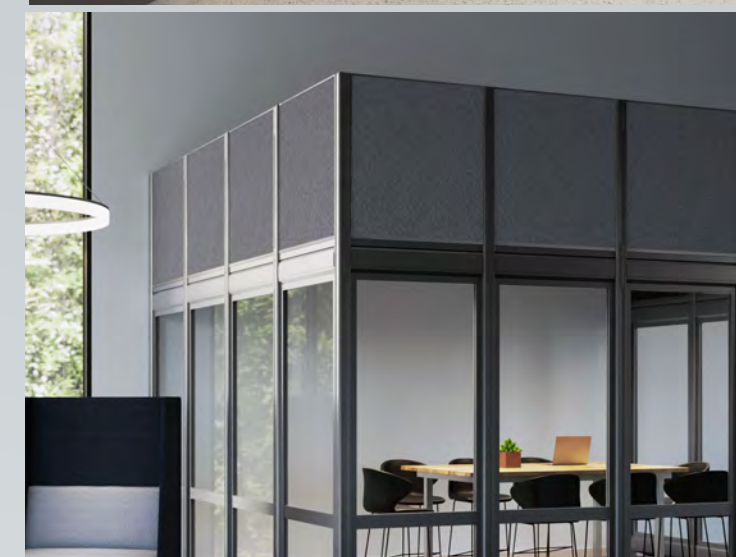

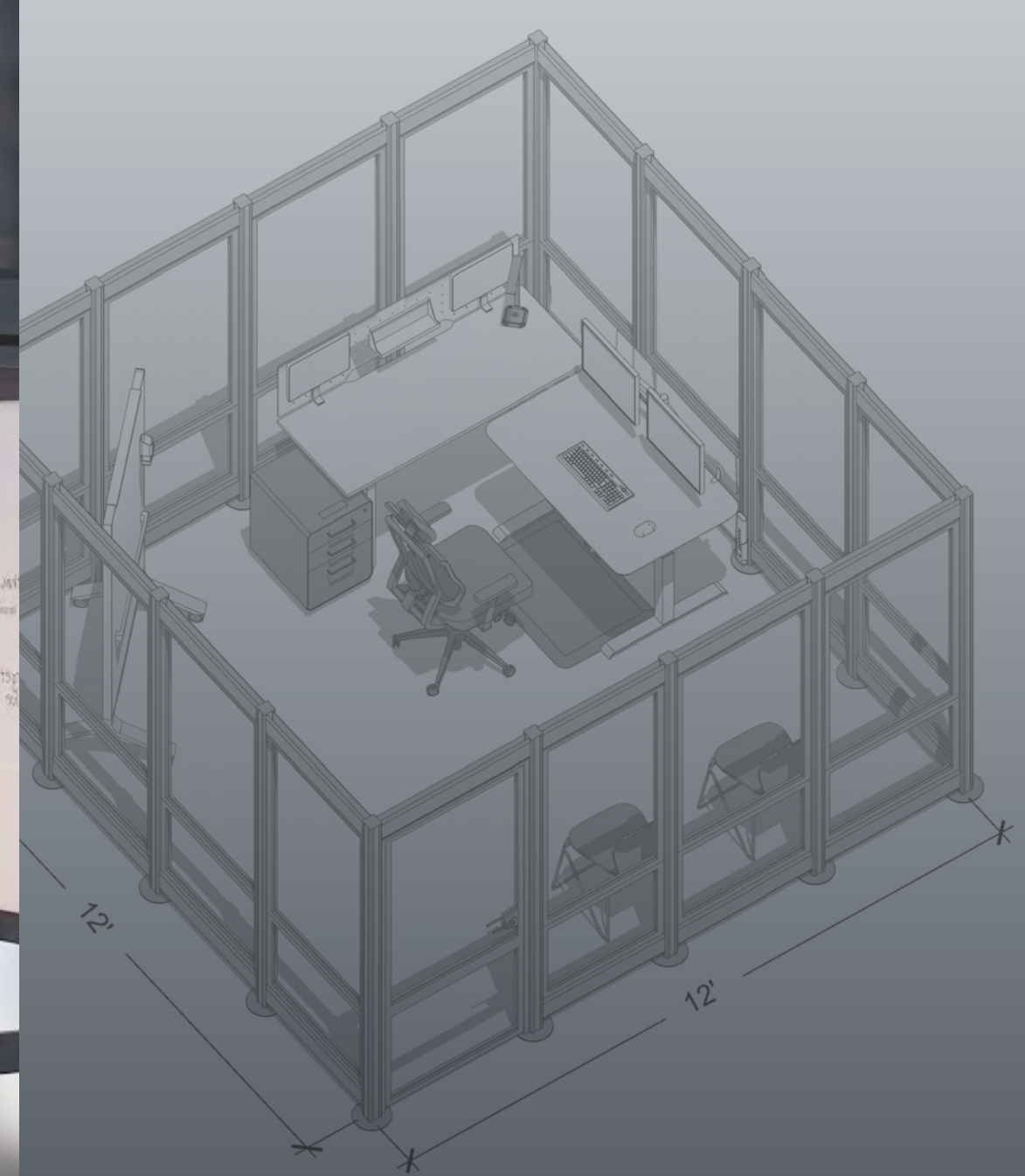

# PRIVATE OFFICES

Create a dedicated office or focus space for anyone who needs some quiet time. Office sizes can even scale to accommodate small teams and include lockable doors for added privacy.

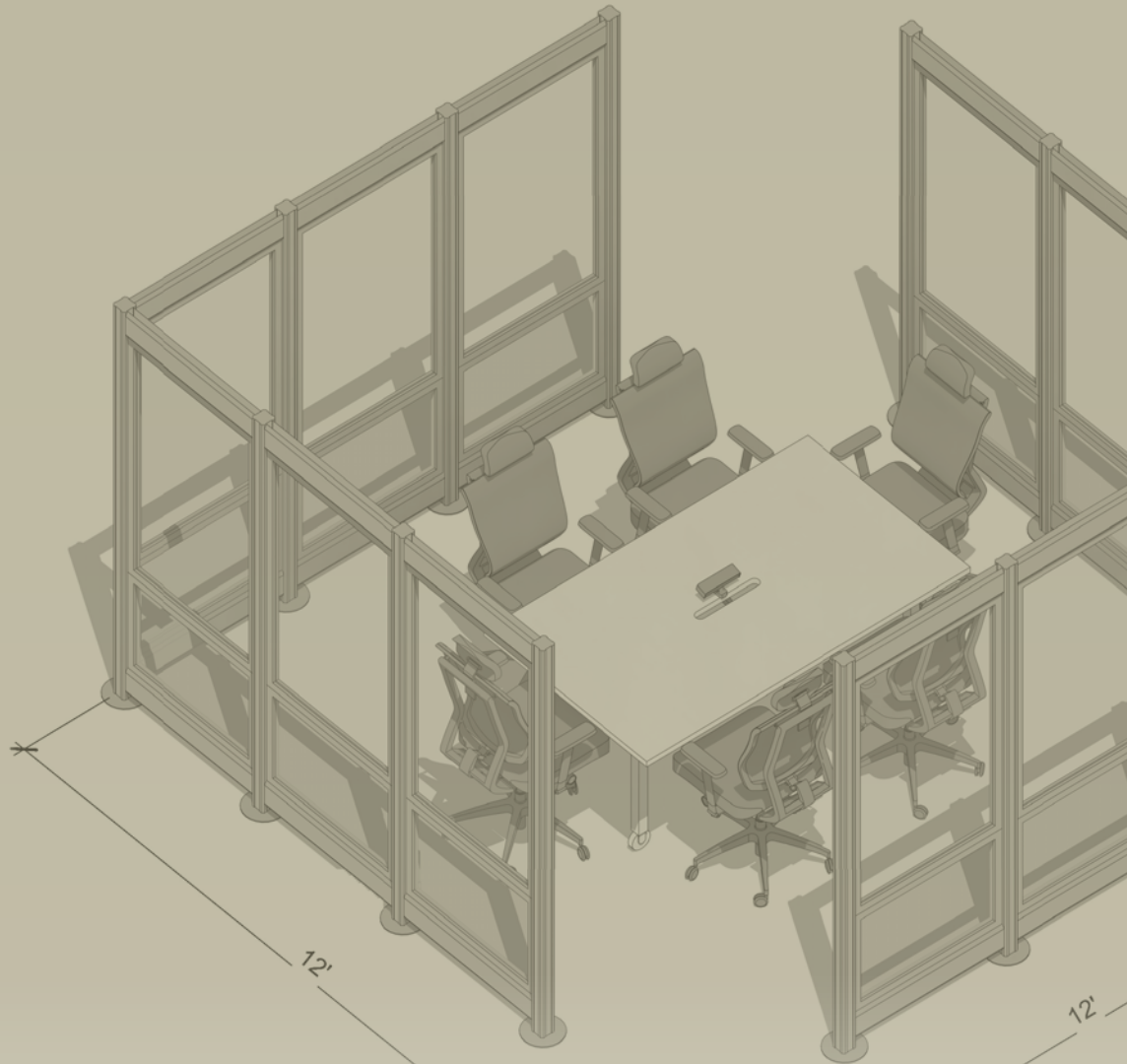

# MEETING SPACES

Combine walls, meeting tables, or soft seating to create inviting spaces where people can gather to collaborate or simply escape and recharge.



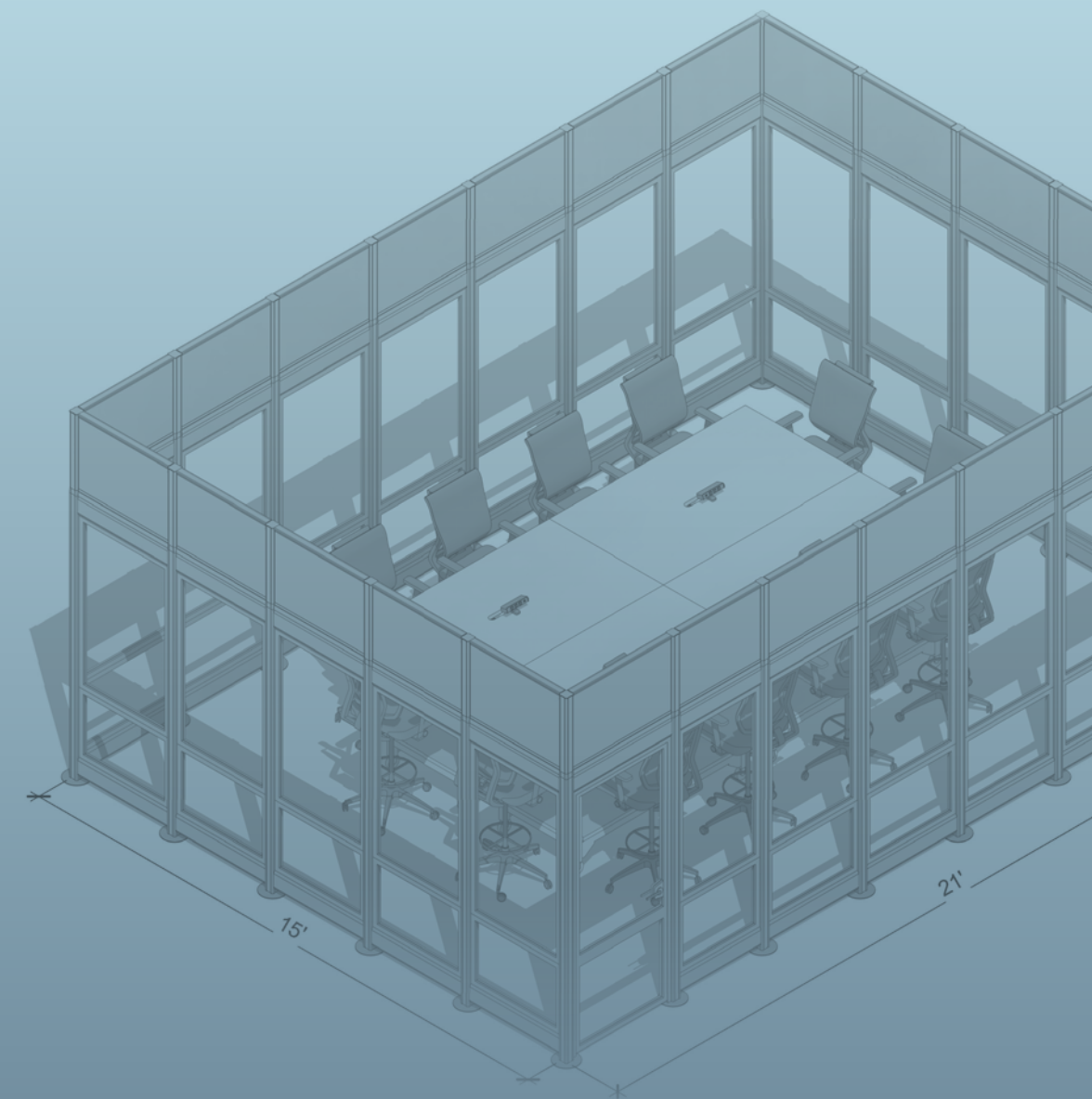

# BOARD ROOM

Build a large space for big groups to meet and collaborate with felt extension panels to dampen sound and keep conversations private.

POTENTIAL OFFICE

## Free Space Plan

It all starts with a plan. Our in-house design team can quickly create solutions customized to your unique needs and show you how to evolve your space, so it works for you today, tomorrow, and into the future.

## Easy Ordering

You don't have to find a dealer or wait around for confusing quotes. Simply call and work directly with a dedicated Customer Success Manager to quote, order, and project manage your installation.

## Fast Delivery & Install

With products that are in-stock and ship quick, you can be installed and up and working fast. In fact, most projects can go from ordered to fully installed for free\* in as little as 15 days.



Call 1-855-240-8970  
or visit [Vari.com/Walls](https://Vari.com/Walls)  
to learn more.

**vari**®

\*Free delivery in the contiguous US. Free installation on qualifying orders in the contiguous US. See [vari.com/installation](https://vari.com/installation) for more details. | Availability subject to change  
Patent and trademark information: [vari.com/patents](https://vari.com/patents) | ©2022 Varidesk, LLC All rights reserved.

